

# GN 1524

Eye screws

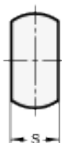

**INOX**  
Stainless Steel

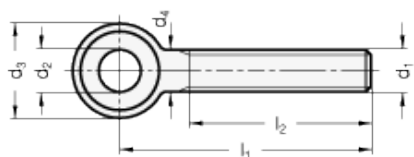

Cylinder head shoulder bolt GN 732 used as bearing pin

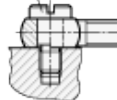

## technical informations

### Specification

Stainless Steel NI

- AISI 303
- turned
- matt shot-blasted

### Information

Stainless Steel-Swing bolts GN 1524 offer a longer threaded bolt contrary to DIN 444.

For stocking purposes cylinder head shoulder bolts GN 732 can be used for the sizes M8, M10 and M12.

Standard Elements	Main dimensions							Weight
Description	d <sub>1</sub>	l <sub>1</sub>	l <sub>2</sub>	d <sub>2</sub> E8	d <sub>3</sub> -0.4	s -0.2	d <sub>4</sub>	g
GN 1524-M6-50-NI	M 6	50	40	6	12	8	6	10
GN 1524-M6-60-NI	M 6	60	40	6	12	8	6	15
GN 1524-M6-70-NI	M 6	70	40	6	12	8	6	15
GN 1524-M6-80-NI	M 6	80	40	6	12	8	6	20
GN 1524-M8-50-NI	M 8	50	40	8	16	10	8	25
GN 1524-M8-60-NI	M 8	60	45	8	16	10	8	25
GN 1524-M8-70-NI	M 8	70	45	8	16	10	8	30

GN 1524-M8-80-NI	M 8	80	45	8	16	10	8	35
GN 1524-M8-100-NI	M 8	100	45	8	16	10	8	40
GN 1524-M10-50-NI	M 10	50	38	10	20	12	10	35
GN 1524-M10-60-NI	M 10	60	46	10	20	12	10	40
GN 1524-M10-70-NI	M 10	70	50	10	20	12	10	45
GN 1524-M10-80-NI	M 10	80	50	10	20	12	10	55
GN 1524-M10-100-NI	M 10	100	50	10	20	12	10	65
GN 1524-M10-120-NI	M 10	120	50	10	20	12	10	75
GN 1524-M12-50-NI	M 12	50	35	12	25	14	12	60
GN 1524-M12-60-NI	M 12	60	42	12	25	14	12	70
GN 1524-M12-70-NI	M 12	70	52	12	25	14	12	75
GN 1524-M12-80-NI	M 12	80	60	12	25	14	12	85
GN 1524-M12-100-NI	M 12	100	60	12	25	14	12	100
GN 1524-M12-120-NI	M 12	120	60	12	25	14	12	115
GN 1524-M12-130-NI	M 12	130	60	12	25	14	12	125
GN 1524-M16-70-NI	M 16	70	49	16	32	18	16	140
GN 1524-M16-80-NI	M 16	80	59	16	32	18	16	155
GN 1524-M16-100-NI	M 16	100	77	16	32	18	16	180
GN 1524-M16-120-NI	M 16	120	80	16	32	18	16	210
GN 1524-M16-140-NI	M 16	140	80	16	32	18	16	245
GN 1524-M16-160-NI	M 16	160	80	16	32	18	16	275
GN 1524-M20-100-NI	M 20	100	75	20	40	22	20	300
GN 1524-M20-120-NI	M 20	120	95	20	40	22	20	346
GN 1524-M20-140-NI	M 20	140	100	20	40	22	20	390
GN 1524-M20-160-NI	M 20	160	100	20	40	22	20	438



STANDARD MACHINE ELEMENTS WORLDWIDE